

Photo Controls

Field Installable

Dimensions & Temperature Data

Photo Control Component



Photo Cell Field Kits For KWP, KF, KFSS Series (400W. Max.)*

CATALOG NUMBER	Volts	Frequency
HUB2PC120FK	120 VAC	50/60 Hz
HUB2PC277FK	208-277 VAC	50/60 Hz
HUB2PC347FK	347 VAC	50/60 Hz

For Harsh NEMA 4X & Class I, Div. 2 Locations*



Photo Cell Field Kits with FSBC drilled cover

CATALOG NUMBER	Volts
VMFSPC1	120 VAC
VMFSPC2	208-277 VAC
VMFSPC3	347 VAC



Factory Sealed

For All Environments



Photo Cell Field Kits with HKB-GL box & cover

CATALOG NUMBER	Volts
VMHKPC1	120 VAC
VMHKPC2	208-277 VAC
VMHKPC3	347 VAC



Factory Sealed

Class I, Div. 1 BCD NEMA 3, 4X
Class II, Div. 1&2, EFG IP66
Class III *40°C ambient T3 Rated

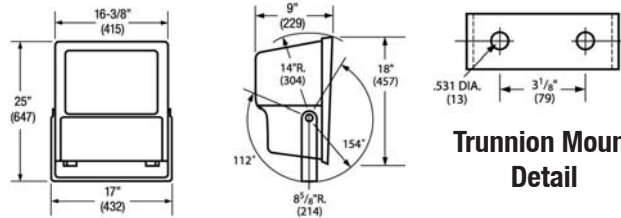

Lamp Type	Wattage & ANSI Code	Ambient °C	Temp. Code CL1, Div. 2	Temp. Code CL1, Zone 2 ExnRⓄ	Supply Wire
HPS	150 S55	40°Ⓞ	T2B	T4	90°C
		55°	—	—	—
HPS	250 S50	40°Ⓞ	325°C	T3	90°C
		55°	—	—	—
HPS	400 S51	40°Ⓞ	360°C	T3	90°C
		55°	—	—	—
HPS	1000 S52	40°	380°C	T2	110°C
		55°	—	—	—
MH	175 M57	40°Ⓞ	350°C	T3	90°C
		55°	—	—	—
MH	250 M58	40°Ⓞ	350°C	T4	90°C
		55°	—	—	—
MH	400 M59	40°Ⓞ	350°C	T3	90°C
		55°	—	—	—
MH	1000 M47	40°	440°C	T2	110°C
		55°	—	—	—
MHP	150 M102	40°	350°C	T3	90°C
		55°	350°C	—	90°C
MHP	175 M137	40°	350°C	T3	90°C
		55°	350°C	—	90°C
MHP	200 M136	40°	350°C	T3	90°C
		55°	350°C	—	90°C
MHP	250 M138	40°	350°C	T3	90°C
		55°	350°C	—	90°C
MHP	320 M132	40°	365°C	T3	90°C
		55°	—	—	—
MHP	350 M131	40°	350°C	T3	90°C
		55°	—	—	—
MHP	400 M135	40°	350°C	T3	90°C
		55°	—	—	—

ⓄOption NR; requires sealed entry

ⓄT-Codes measured @ 40°C; Ⓞ Listed for 25°C operation



KILLARK®

RACO® BELL® KILLARK® HAWKE® CHALMIT®

3940 M.L. King Dr., St. Louis, MO 63113
Tel: 314-531-0460 Fax: 314-531-7164
www.hubbell-killark.com

TF-KF-FLOODS



KILLARK®



KF Series

150 - 1000W HID

Aluminum Floodlights

now with

2009 EISA Compliant
Pulse Start Metal Halide



**Wet, Harsh &
Hazardous Locations**

Distributed by:

